

FL600-SS



4 *AAA batteries (Not included)

CONTENTS

INSTALLATION GUIDE	2
<i>Prepare Door and Check Dimensions</i>	3
<i>Install Latch and Strike</i>	4
<i>Install the Exterior Knob</i>	5
<i>Install the Interior Knob</i>	6
OPERATION GUIDE	7
APP GUIDE	10
<i>Account Registration</i>	10
<i>Pairing Your Lock</i>	11
<i>App Unlock/Lock</i>	13
<i>Member Management & Fingerprint/Code Input</i>	15
<i>Create Smart Scenes</i>	17
<i>Setting</i>	18
<i>Device Information Set Up</i>	19
SPECIFICATIONS	20
FCC WARNING	21

INSTALLATION GUIDE

Packing List

A



Exterior Knob
1 PC

B



Interior Knob
1 PC

C

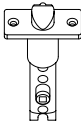

Latch
1 PC

D

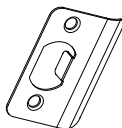

Strike Plate
1 PC

E

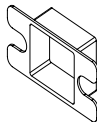

Strike Box
1 PC

F



Screw A
4 PCS

G



Screw B
3 PCS

H



Key
2 PCS

I

User Manual
1 PC

Tools Required



Phillips Screwdriver



Tape Measure

Prepare Door and Check Dimensions

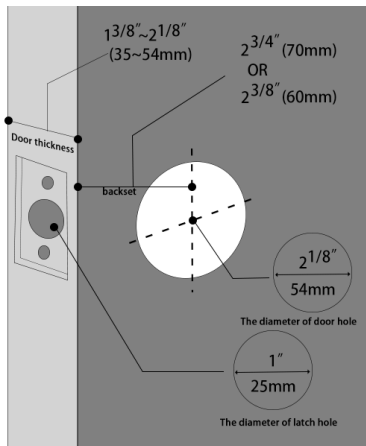

Install Latch and Strike

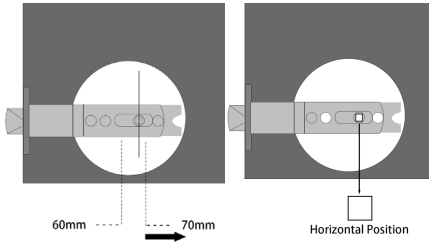

1. Hold the latch in front of the door hole so that the latch is flush with the door edge.
2. Press the square-shaped hole and pull the latch to set the latch backset to 60mm(2-3/8") or 70mm(2-3/4") to fit your door hole.
3. Make sure the square-shaped hole places the horizontal position.

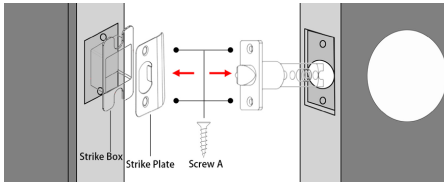

1. Insert the latch into the door hole, and tighten Screw A to fix the latch.
2. Install strike box and strike plate with screw A into the door frame.

Remove the Battery Cover

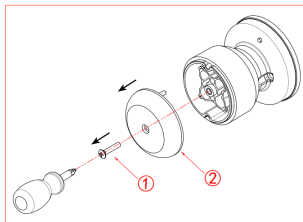
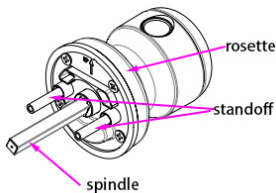

As the left figure shows, use the screwdriver to remove the Screw C and pull out the battery cover.

Install the Exterior Knob

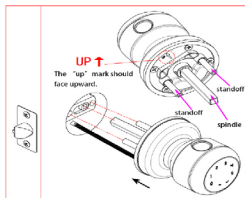

As shown left, install the Exterior Knob onto the door with the standoffs going through the circular holes on the Latch, and spindle going through the square-shaped(center)hole.

Install the Interior Knob

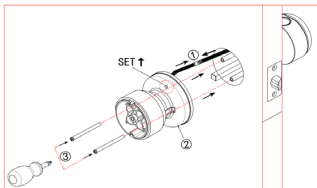

The set button above the rosette should face upward.

Plug the control wire male plug to female socket. Install the rosette onto the door with the standoffs aligning the circular holes and spindle aligning the square-shaped (center) hole. Then insert the Screw B into the circular holes and tighten them to secure the rosette.

Install the Battery Cover

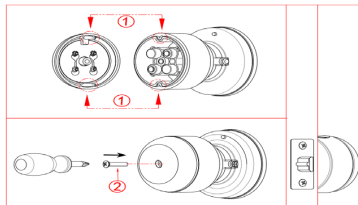
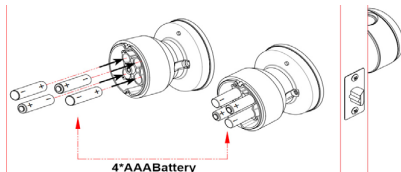

Install 4 AAA battery and tighten the Screw C to secure the battery cover.

PLEASE DO NOT USE LITHIUM BATTERIES OR RECHARGABLE BATTERIES.

OPERATION GUIDE

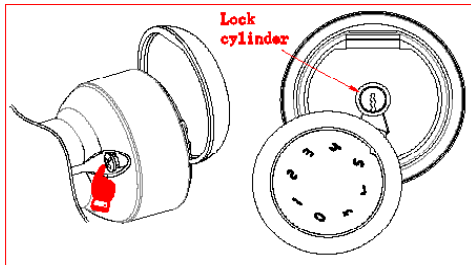

Key To Unlock

1. Press the screw in the back of the Exterior Knob, and the knob head cover will come out for you to easily pull and turn.
2. Pull out the knob head cover, insert the key and turn the key 90° to unlock, then turn the Exterior Knob to open the door.

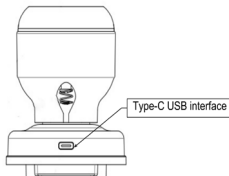

5V Emergency Power

Type-C USB interface is used to connect regular 5V power bank to activate the lock in case the battery is dead.

Note: The Type-C USB interface is only used for emergency unlock and cannot be used for battery charging.

Low Power Indication

After being unlocked by fingerprint or APP successfully, the buzzer beeps once, and the fingerprint identification area flashes green and then flashes red.

Passage Mode

Press the SET BUTTON on the back of Interior Knob once and validate the fingerprint to enable the passage mode.
Press the SET BUTTON once to disable the passage mode.

Restore the Factory Setting

Press the set button for 8 seconds. After that, you will hear the long beep and the fingerprint identification area flashes green.
Any fingerprints can unlock the lock.

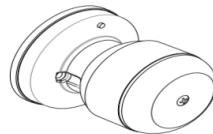

Action	Buzzer	Indicator
Power on	Beep once	Inactive
Fingerprint added successfully	Long Beep	Stay green for a while
Unlocking successful	Beeps once	Blinks green once
Unlocking failure	Beeps twice	Blinks red once
Low battery warning	Beeps once	Blinks green then blinks red
Resetting successful	Long Beep	Blinks green once

APP GUIDE

Scan the Tuya QR Code to download the app or search "Tuya Smart" in APP Store (IOS) and Google Play (Android) for download.

Account Registration

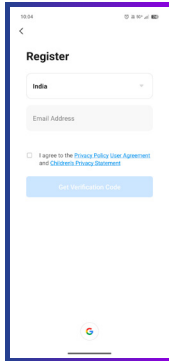
A screenshot of the Tuya Smart app's registration screen. The screen is titled "Register" and features a dropdown menu for country selection with "India" chosen. Below this is a text input field for "Email Address". A checkbox is present with the text "I agree to the [Privacy Policy](#), [User Agreement](#) and [Children's Privacy Statement](#)". At the bottom of the form is a blue button labeled "Get Verification Code". The screen is framed by a purple border, and the status bar at the top shows the time as 10:04.

Register a new account (Email Address) or log in with an existing account.

Pair the Lock

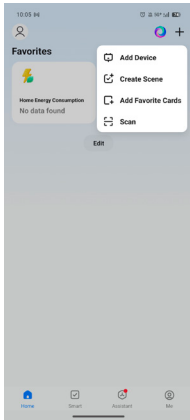

Add the lock.

Turn on your phone's bluetooth and stay near the lock (within 3 meters) Click “Add Device” on the App.

Pair the Lock

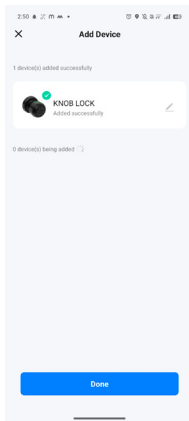

Successful connection! You can click this icon “” to rename the lock or just click “Done” to complete the pairing.

APP Unlock/Lock

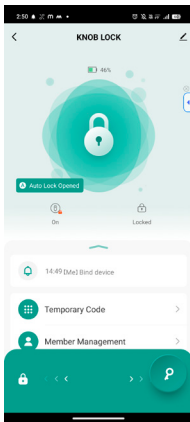

Unlock: Hold and drag the icon“P”



to the icon“



APP Unlock/Lock

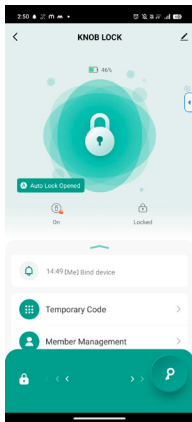

Lock: Hold and drag the icon“” to the icon“”.

Member Management

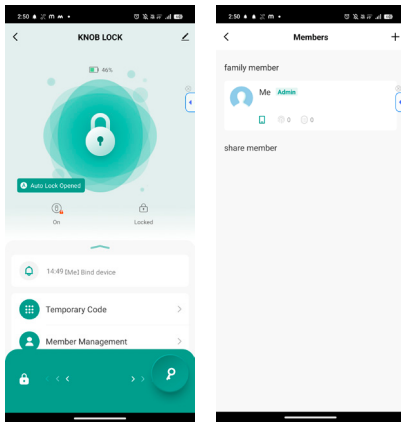

Select “Member Management” and tap “+” to add/share/cancel members.

Fingerprint/Code Input

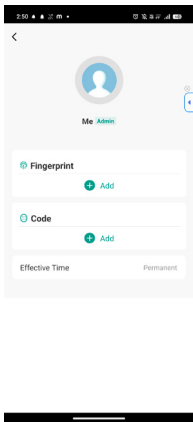

Press “Me” and follow the instructions to add fingerprints or codes.



- 1. Place a finger on the fingerprint recognition area several times from multiple angles.**
- 2. You can enable notifications through the icon and choose the push mode.**

Creat Smart Scenes

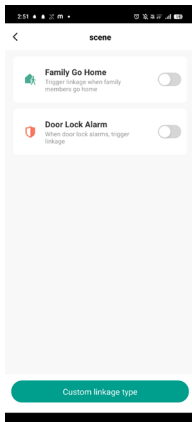

Select “Smart Scenes” on the screen. Then choose the scenes you prefer to set intelligent interactions.

Setting

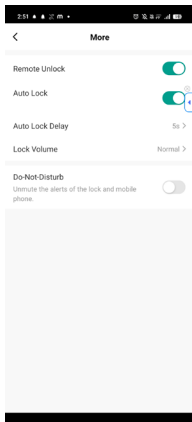

Choose “Settings” to turn on/off “Remote Unlock” and set up lock volume.



Note: Remote unlocking requires a gateway connection.

Device Information Set Up

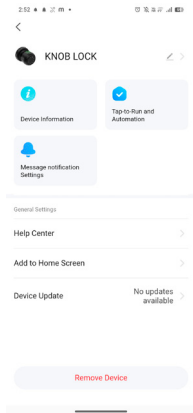

Press the icon “” to check and set up the relevant information.

SPECIFICATIONS

Technical Parameters	
Name	Parameter Description
USB	Type-C/5V2A
Fingerprint Capacity	18
Password Capacity	20
Low power warning	4.8V±0.2
Voltage range	4.5~6.5V
Stand-by current	≤90μA
Working current	≤500mA
Unlock time	≈1.5sec
Working temperature	14 °F ~131 °F (-10°C ~55°C)

FCC WARNING

Any changes or modifications not expressly approved by the party responsible for compliance could void the user's authority to operate the equipment.

Note: The equipment has been tested and found to comply with the limits for a Class B digital device. Pursuant to part 15 of the FCC Rules. These limits are designed to provide reasonable protection against harmful interference in residential installation. This equipment generates uses and can radiate radio frequency energy and, if not installed and used in accordance with the instructions, may cause harmful interference to radio communications. However, there is no guarantee that interference will not occur in a particular installation. If this equipment does cause harmful interference to radio or television reception, which can be determined by turning the equipment off and on, the user is encouraged to try to correct the interference by one or more of the following measures:

- Reorient or relocate the receiving antenna.
- Increase the separation between the equipment and receiver.
- Connect the equipment into an outlet on a circuit different from that to which the receiver is connected
- Consult the dealer or an experienced radio/TV technician for help.

This device complies with part 15 of the FCC Rules. Operation is subject to the following two conditions: (1) This device may not cause harmful interference, and (2) this device must accept any interference received, including interference that may cause undesired operation.

Manage Time & Attendance for all your Branches from Head Office



Disclaimer : Specifications can be changed without prior notice.

1. Buying and Selling eSSL products online is prohibited and is termed as illegal
2. Installation / Technical support / Training to end user is the responsibility of the installer or dealer
3. eSSL do not support end user directly, if they want support charges will be applicable



Enterprise Software Solutions Lab Pvt. Ltd. (Corporate-Office)

#24, 23rd main, Shambhavi Building, J P nagar 2nd phase, Bengaluru - 560078

www.esslsecurity.com | sales@esslsecurity.com | Ph : 91-8026090500