

INSTRUCTION MANUAL

Fingerprint Door Lock

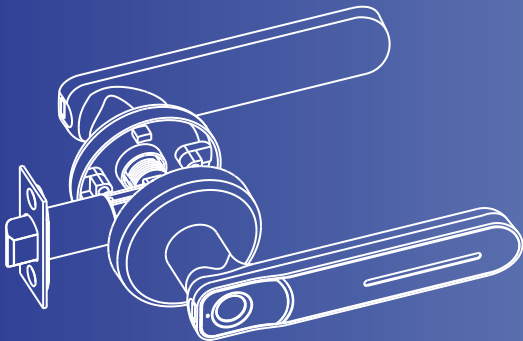

FL700

Before installing the smart lock,
please read this manual carefully,
and keep it in a safe place, for future reference.

TABLE OF CONTENTS

PRODUCT OVERVIEW STYLE A.....	01
PRODUCT OVERVIEW STYLE B.....	02
DOOR LOCK INSTALLATION DIAGRAM.....	03
MEASURING DOOR DIMENSIONS.....	04
DOOR OPENING DIRECTION.....	05
1、 Door Opening Direction.....	05
2、 Installation.....	06
DOOR LOCK INSTALLATION TUTORIAL.....	07
TIPS AND PARAMETERS.....	10
HOW TO UNLOCK & LOCK.....	11
1、 Unlocking And Closing.....	11
2、 Add Fingerprint:.....	11
3、 Forced Initialisation:.....	11
APP OPERATION INSTRUCTIONS.....	12
1、 App Registration And Login.....	12
2、 Add Bluetooth Door Lock.....	13
3、 Bluetooth Door Lock Home.....	14
4、 Fingerprint Management.....	15
5、 App Normally Open Mode And Anti-Lock Setting.....	18
6、 Member Management-Administrator Add.....	19
7、 Member Management—Ordinary Members Added.....	20
8、 Deletion Of Family Members.....	20
9、 Open Door Record And Equipment Alarm.....	21
10、 Restore Factory Settings.....	22
11、 Product Technical Parameters.....	23

PRODUCT OVERVIEW STYLE A

Front Lock View

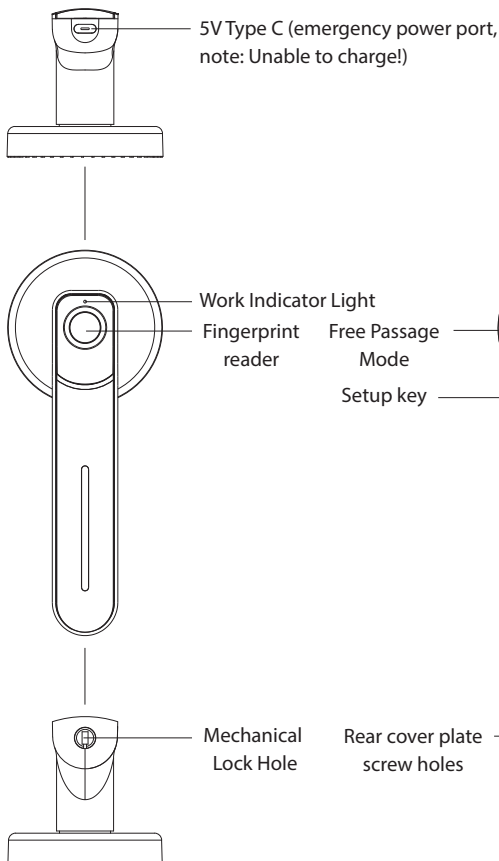

Rear Lock View

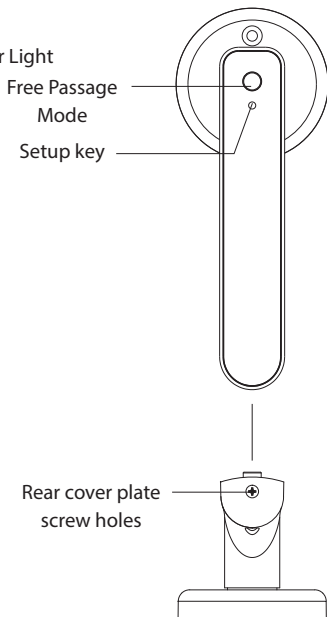

PRODUCT OVERVIEW STYLE B

Front Lock View

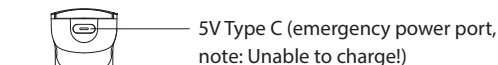

Rear Lock View

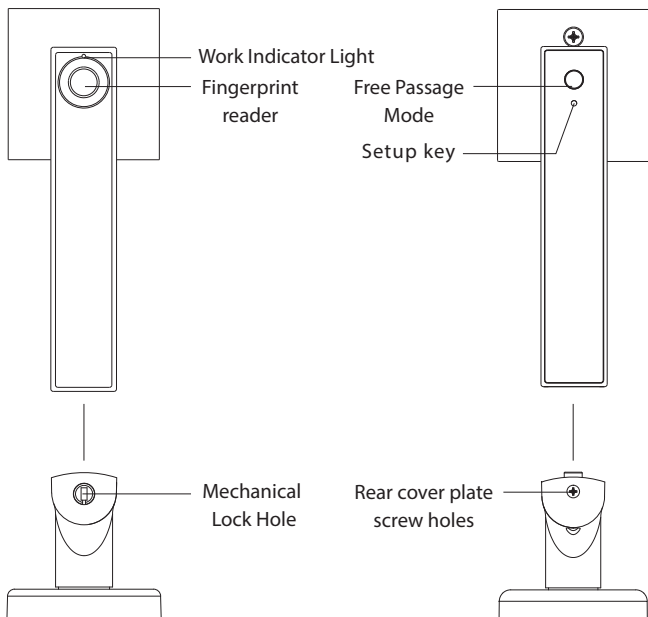

DOOR LOCK INSTALLATION DIAGRAM

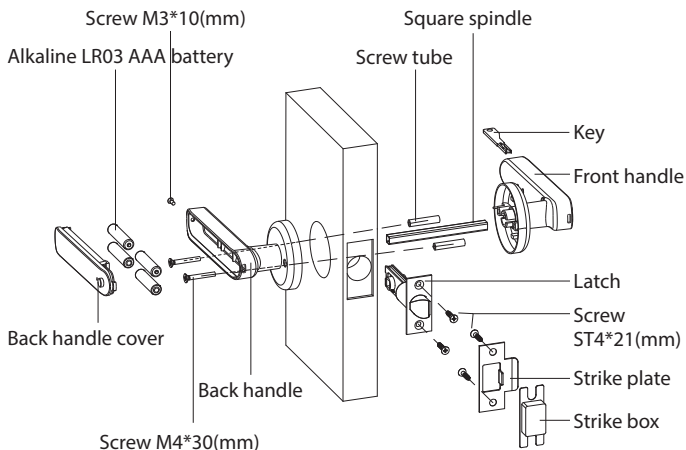

Tips ▲ (1) Install the spindle into the latch, and get the cables through the middle of spindle.

(2) Fix the rear fixing plate, front handle with two screws on the door.

Attachment

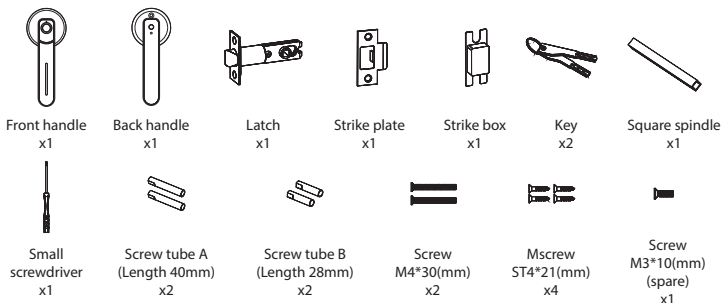

Tips ▲ Open the product package. Check that the following accessories are included.

MEASURING DOOR DIMENSIONS

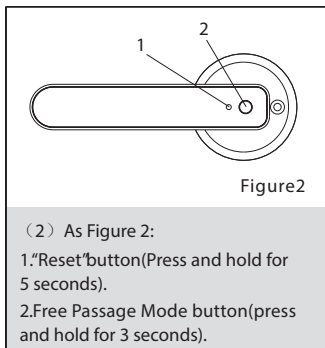
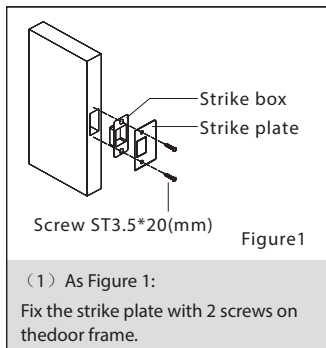

Measure the Door Size

Make sure door thickness is 30mm-50mm, door hole diameter is $\Phi 54\text{mm}$, measure backset size is 60/70mm with the deadbolt.

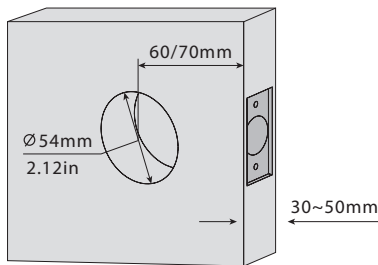

Tips  (1) Available door thickness 30~50mm. If the door is over this range. Please contact us for more information.

(2) Please select the correct accessories according to your door thickness.

DOOR OPENING DIRECTION

1、Door Opening Direction

(1) Right handle opening

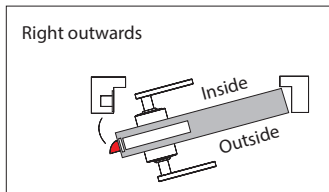
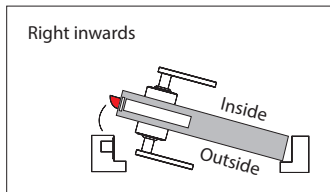

(2) Left handle opening

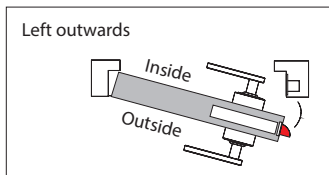
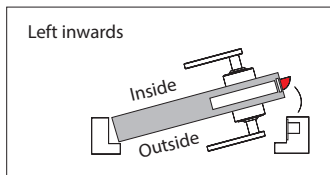

(3) Open the door with your left or right hand.

According to the direction of the door opening, As shown in the figure below: replace and install it (This product Left/RightUniversal).

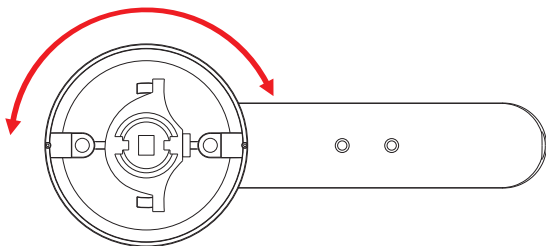

2、Installation

Please follow the below steps to install the lock

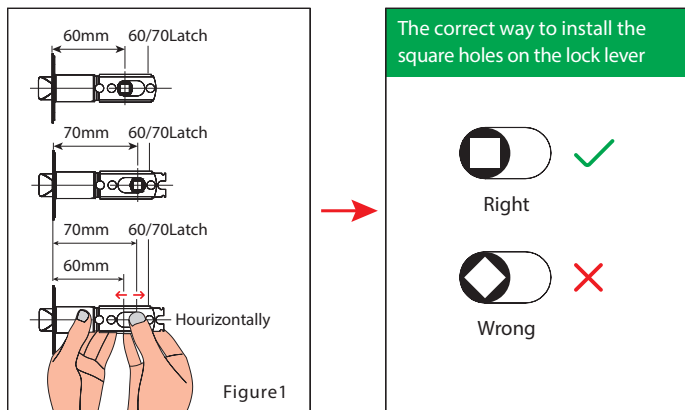

(1) As Figure 1: Adjust the back distance of the lock body as required(60~70mm). When adjusting the back distance, hold the square hole on the lock lever with your hand and push it to the edge of the lock lever, front and rear the hole must be horizontal.

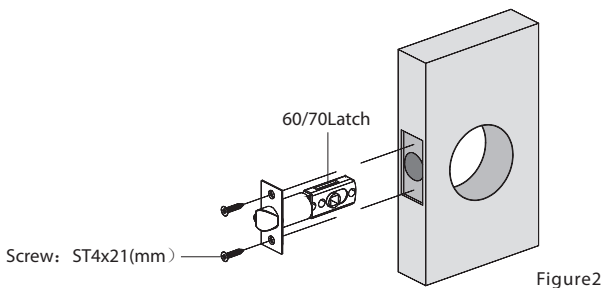

(2) As Figure 2: Fix the latch with 2 screws.

DOOR LOCK INSTALLATION TUTORIAL

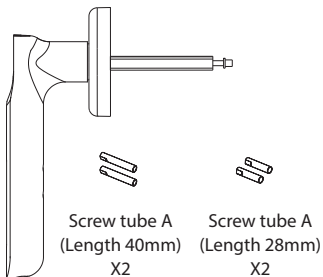
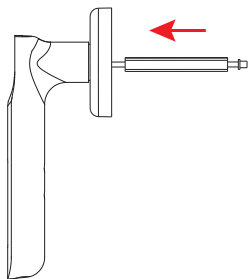

(1) Put the front handle wire through the middle of the 100 square cylinder (Door thickness 41-50mm with screw tube A, Door thickness 30-40mm with screw tube B).

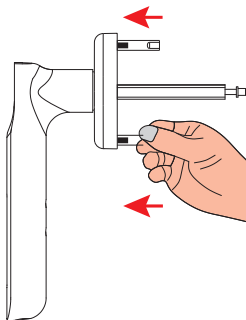

(2) Screw the stud into the front handle full tooth screw and tighten it with pliers.

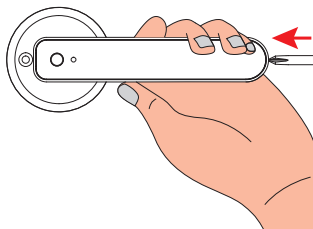

(3) Use a screwdriver to remove the screws on the rear handle cover.

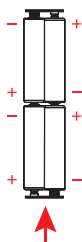

Tips  Battery installation direction.

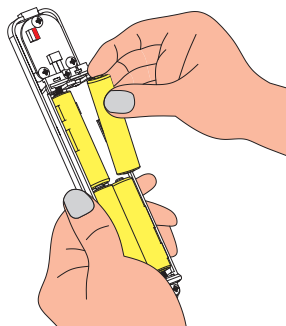

(4) Put four alkaline LR03 AAA batteries into the battery compartment.

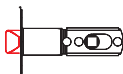

Latch installation direction
(inside open)

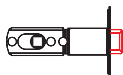

Latch installation direction
(outside open)

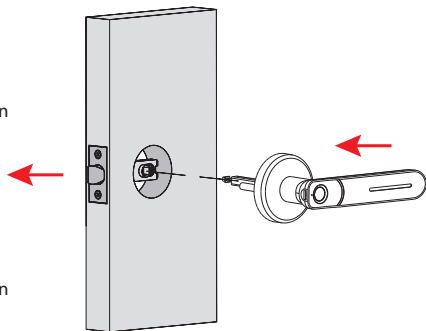

(5) Align the front handle with the door hole and pass through the lock hole.

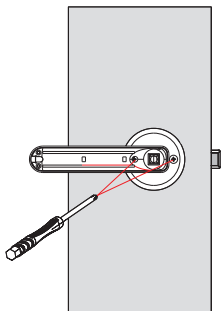

(6) Fasten the front and rear handle connections with screws and tighten the screws.

Tips  Direction of wire insertion.

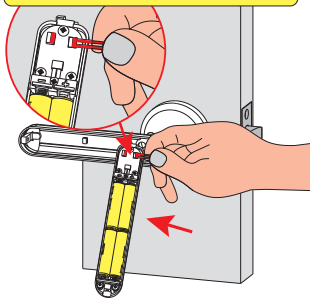

(7) Insert the wire terminal into the circuit board slot.

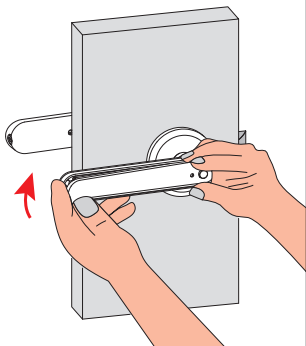

(8) Put the handle cover into the back handle.

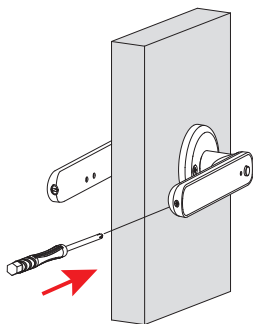

(9) Tighten the screws securing the rear handle cover.

TIPS AND PARAMETERS

Check Points After Installatio !

- (1) The smart lock is horizontal with the door.
- (2) The latch bolt must works smoothly and flexibly.
- (3) Please make sure the cable will not be pressed.
- (4) Fix the handle with two screws, and check if it works fine.
- (5) Please choose a good quality Lr03 alkaline battery,and ensure that all 4 batteries are new, and cover the battery cover.

Tips

- (1) This lock is equipped with mechanical keys for manual unlocking. Remove mechanical keys from the package and keep them in a safe place and always have access to them.
- (2) Please replace the batteries as soon as you heard the low voltage alarm, Don't mix old and new batteries or different battery types.
- (3) This lock is not designed to be exposed to direct sunlight or rain. It is not water proof IP rated.
- (4) Keep your fingers clean and dry when using this lock.
- (5) When using the mobile phone Bluetooth App, keep a limited distance from the door lock within 5-10 meters.

Parameters

Unlocking Methods	Fingerprint/Tuya App/Key
Direction of Door Opening	Left/Right(Universal)
Power Supply	4*LR03 AAA Batteries/External USB Power Supply(for Emergency)
Number of Users	Fingerprint max 50
Emergency power supply	5V (DC)
Low voltage alarm	4.8V±0.2V(When the battery is low,the red light prompts five times)
Operating temperature	-25℃-65℃

LOCAL OPERATING INSTRUCTIONS

All users entered locally are administrators by default, and will be automatically associated with the "Family Owner" account, and the registration of ordinary members needs to be operated in the mobile phone app. If you have already registered as administrator, you need to verify the administrator when you add or delete users again; when the product is not registered, it is in experience mode, any fingerprint can unlock the door, after registration, illegal fingerprints can not unlock the door.

1、Unlocking And Closing:

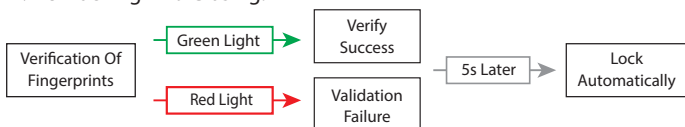

2、Add Fingerprint:

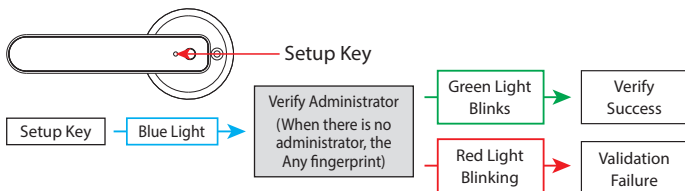

3、Forced Initialisation:

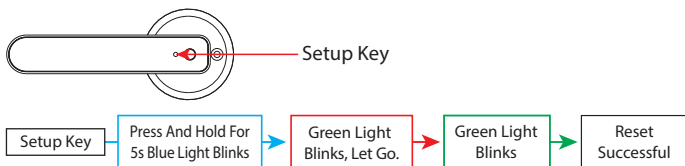

Tips

- (1) The 1st user please set fingerprint in the app.
- (2) The unlocking information set in the local command system will grant administrator privileges by default, and will be automatically associated with "family members" in the app.
- (3) Don't use local manual programming unless necessary, a mobile app is much easier to operate.

APP OPERATION INSTRUCTIONS

Tuya App Operating Instructions

"Tuya Smart App" is a smart device management app provided by Tuya to end consumers. Through "Tuya Smart App", you can conveniently configure and control your purchased whole-house smart products, configure your favourite scenarios and automation solutions, share your smart devices with your family and friends, and enjoy the fun of whole-house intelligence.

App acquisition: Search for "Tuya Smart" in the mobile phone application market or "Apple Store" or scan the QR code below to download.

※ This document takes the Smart Life App as an example to explain the App door lock panel function in detail.

1、App Registration And Login

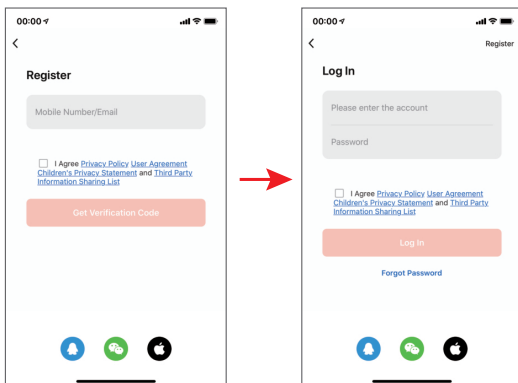

- (1) App registration: Accounts without an app choose to register or login via SMS verification code.
- (2) Click "Create New Account", you will enter the registration page of the account, get the SMS verification code and set the password according to the prompts.
- (3) If you have an existing account, you can click "Login with existing account" to log in to the App, and the login method supports password, verification code, social account and other login.

2、Add Bluetooth Door Lock(must first turn on the mobile phone Bluetooth Function)

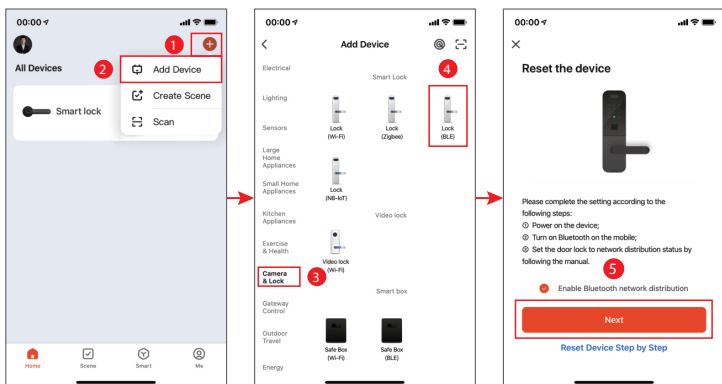

- (1) Click the "Add Device" icon on the home page of the app.
- (2) Touch the fingerprint head to wake up, wait for the mobile phone to scan the device to select "Add", press the "+" mark to add the device to complete.
- (3) Wait for the device to be added, and the smart lock interface appears, indicating that it has been added successfully.

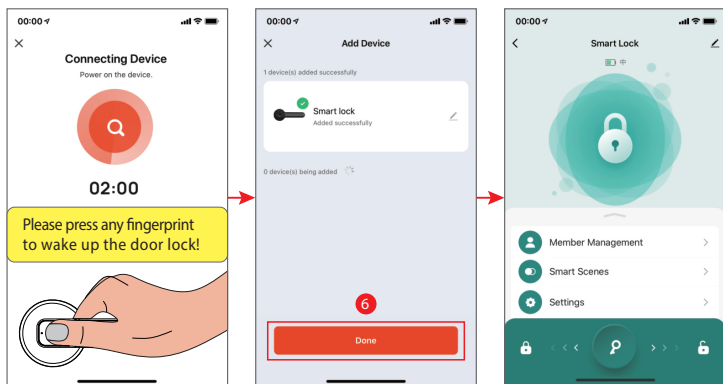

3、Bluetooth Door Lock Home

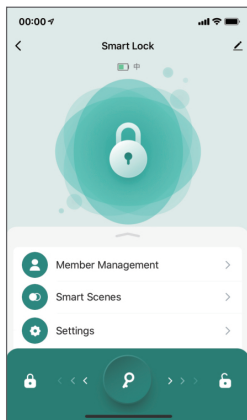

- (1) The top of the homepage shows the device name and current battery status, and the bottom of the homepage contains "Open Record", "Member Management", "Smart Apps" and "More Settings".
- (2) The homepage centre will show the connection status of Bluetooth, if it is connected, you can slide "Unlock" to the right to open the door lock directly, and slide "Close" to the left to close the lock (please make sure that the Bluetooth of your mobile phone has been turned on, and it is recommended to do this operation within 5 meters). If Bluetooth is not connected, it will show "Unable to connect Bluetooth" (Bluetooth cannot be turned on directly through the App).

4、Fingerprint Management

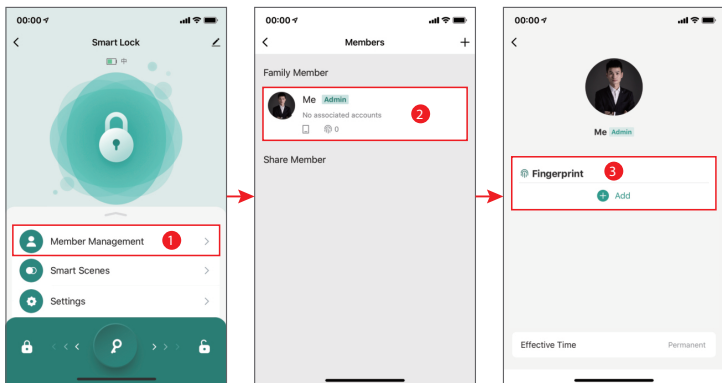

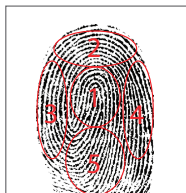
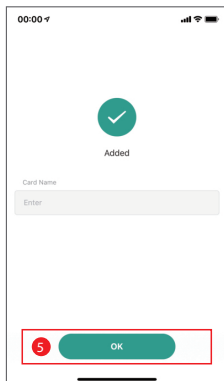
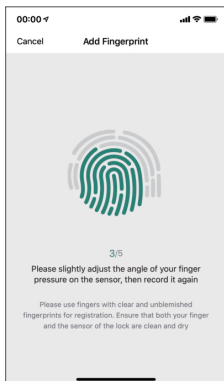
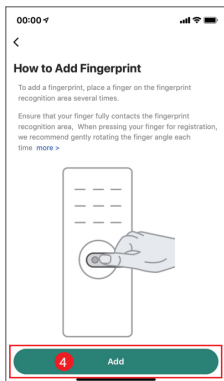

Tips ⚠ As shown in the picture, when entering fingerprints to ensure that the 5 fingerprint areas are completely entered, the recognition flexibility will be increased by more than 99.9%!

- (1) The belly of the finger is used to make the entry, not the fingertip.
- (2) The same fingerprint needs to be scanned from multiple angles.
- (3) Multiple fingerprints can be scanned for the same user.
- (4) Please keep your finger clean, not too dry or too wet.

- (1) Select the "Family Member" account with corresponding authority in the "Member Management" portal on the homepage (Note: the associated administrator will have administrator authority, while the associated ordinary member will only have ordinary user authority).
- (2) Click "Start Collecting", the blue light will be on to enter the fingerprint collecting interface, press the fingerprint green light to release, each fingerprint needs to be collected 5 times, the indicator light will be off, the fingerprint collection is successful.
- (3) Connect to the door lock via Bluetooth, administrator can collect fingerprints for himself/herself or other family members.
- (4) Unlock the door with fingerprint, green light for successful verification and red light for failed verification.

5、App Normally Open Mode And Anti-Lock Setting

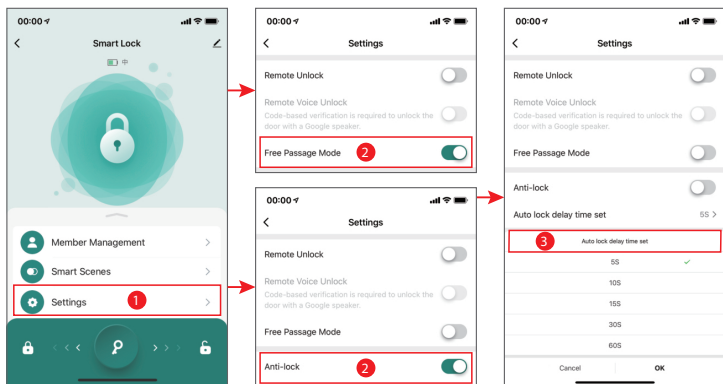

- (1) Slide the "More Settings" menu at the bottom of the main interface, and choose to open or close the "Always Open Mode". When the door lock opens the "always open mode", the door lock will not be locked, convenient to enter and exit at any time, and after the user verifies the fingerprint, the "always open mode" will be closed by default. You can also turn off the "always open mode" in App, or slide the lock to the left to turn off the "always open mode".
- (2) Open the "More Settings" menu at the bottom of the main interface, and choose to open or close the "Anti-lock Settings". When the door lock is unlocked, only the administrator can unlock the door, ordinary members can't unlock the door, and after the administrator unlocked the door, the "anti-locking mode" will be closed by default (you can also close the "anti-locking settings" in the App).
- (3) "Auto Lock Time Setting", customers can choose the auto lock time according to their needs, after successful verification, the door lock will be closed automatically according to the time. ("Anti Lock Setting" and "Normally Open Mode" can't be opened at the same time. After opening "Anti Lock Setting", "Normally Open Mode" will be closed automatically. When the "Normally Open Mode" is turned on, the "Reverse Lock Setting" will also be turned off.

6、Member Management-Administrator Add

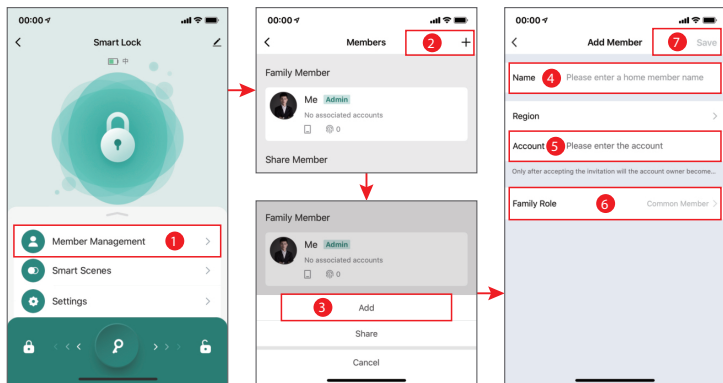

- (1) Click “+” in the upper right corner of the “Member Management” portal, select “Add Member”, enter the member name and Graffiti account, select the permissions and click save to add administrator. user. (Note: the added administrator account must be a registered Graffiti Smart account, otherwise it will not be able to add)
- (2) The added account will receive an invitation message after opening the mobile Graffiti App, and will have the management rights of the device after agreeing.
- (3) All the key information added by this account entrance will be administrator privilege by default.

7、Member Management—Ordinary Members Added

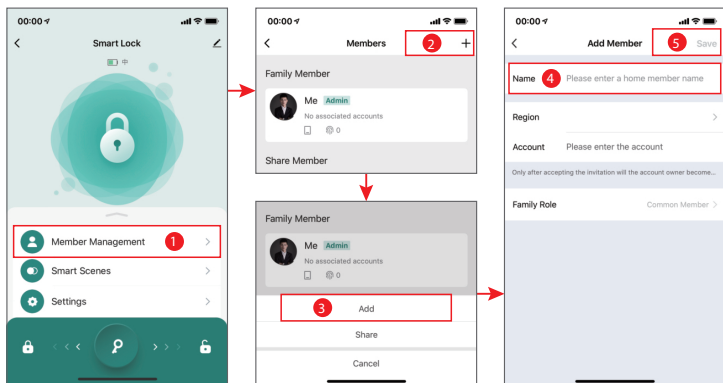

- (1) Click "+" in the upper-right corner, select "Add Member", enter the member name, no need to enter the account number, and click save to add a general member user.
- (2) All key information added by this account portal will be defaulted to ordinary user rights.

8、Deletion Of Family Members

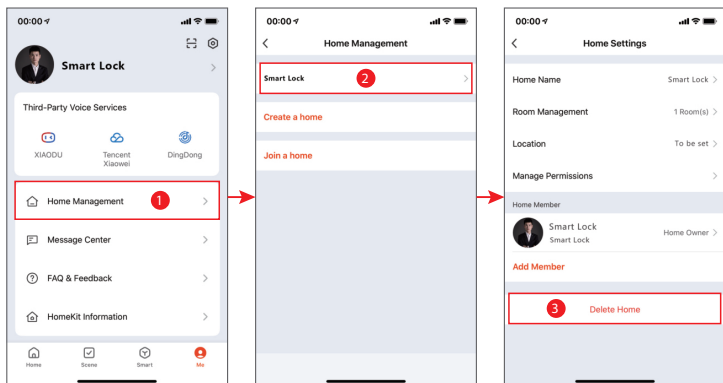

Click my“Family Management”in the lower right corner of the App, select Family to delete or change the usage rights of the added family members.

9、Open Door Record And Equipment Alarm

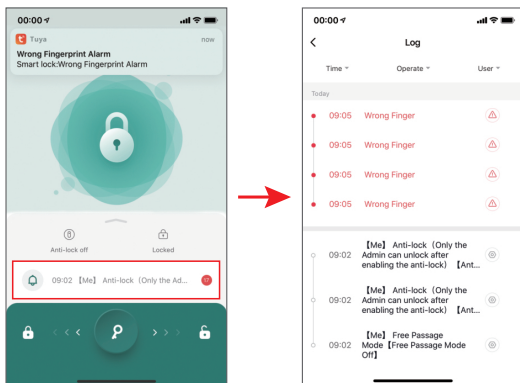

Click on the“Alarm”icon to view the door opening record and trial and error alarms and other information. (Note: When the door lock is connected to the Bluetooth of mobile phone, the open door record and alarm will be shown on the App in real time, otherwise the record will be cached locally in the door lock, waiting for the next time the door lock is connected to the Bluetooth of the mobile phone and opens the door to make up the transmission.

10、Restore Factory Settings

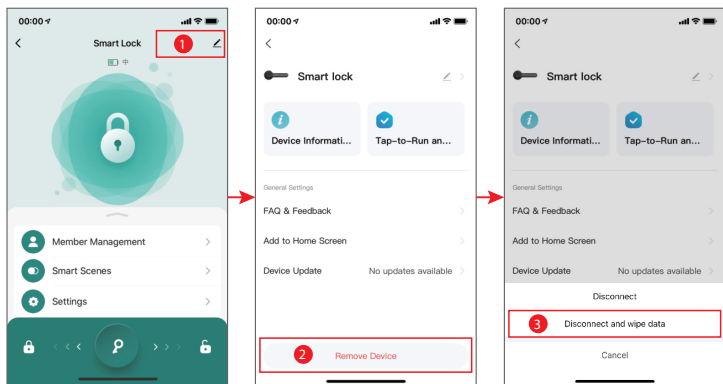

On the main page, click on the icon in the upper right corner, enter the interface and find "Remove Device", select "Unbind and Clear Data".

- (1) When the mobile phone App is in Bluetooth connection status with the door lock, use the restore factory settings operation, all the door lock's local door opening methods will be cleared, and the door lock will be restored to the factory default status, and other users can also re-match the door lock through the App.
- (2) When the mobile phone does not have Bluetooth connection with the door lock, restore the factory settings on the mobile phone App, the door lock will still retain the door opening data unaffected. Other users can re-pair with the door lock through the App, after re-pairing, all the original data on the door lock will be invalid.

- (3) Long press the setup button for 5 seconds → blue light blinks, after 5 seconds the red light blinks to release your hand, a green light appears to indicate successful restoration of factory settings. At this time, all the recorded unlocking information will be cleared, and the App will be automatically unbound at the same time.

11、Product Technical Parameters

SN	FUNCTION	CONTENT	Description
1	Unlocking Method	Fingerprints、Tuya App、Key	5 seconds after fingerprint unlocking to perform lock shutdown, settings can be changed within the app
2	Number Of Users	50 Groups	Fingerprint max 50 (including administrator)
3	Low Voltage Alarm	4.8V±0.2V	When the voltage is lower than 4.8V, the red indicator light will keep flashing 5 times when unlocking the door, please replace the battery in time.
4	Static Current	≥80uA	
5	Dynamic Current	>150mA	
6	Supply Voltage	6V±0.3V	Four 7 dry batteries (please choose high quality alkaline 1.5V batteries), to prevent battery leakage, please replace new batteries within one year
7	Emergency Power Supply	5VDC	USB tyPe-C connection (emergency power supply to unlock the door when the battery is dead)
8	Operating Temperature	-25℃~65℃	
9	Operating Humidity	20%~90%RH	

Manage Time & Attendance for all your Branches from Head Office

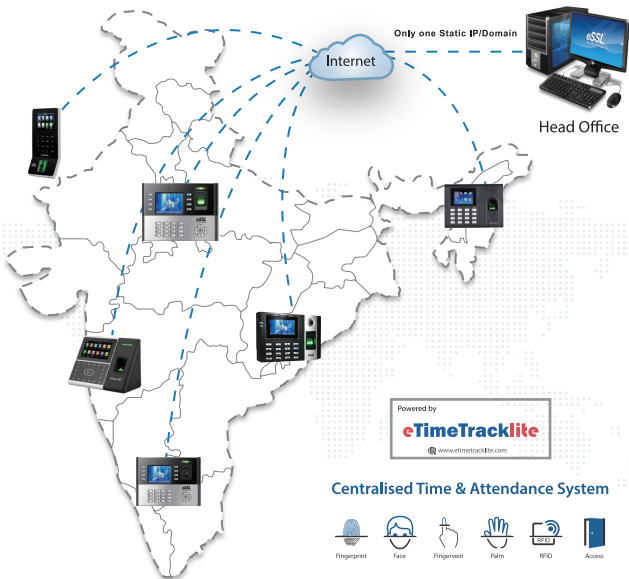

Disclaimer : Specifications can be changed without prior notice.

1. **Buying and Selling eSSL products online is prohibited and is termed as illegal**
2. Installation / Technical support / Training to end user is the responsibility of the installer or dealer
3. eSSL do not support end user directly, if they want support charges will be applicable



Enterprise Software Solutions Lab Pvt. Ltd. (Corporate-Office)

#24, 23rd main, Shambhavi Building, J P nagar 2nd phase, Bengaluru - 560078

www.esslsecurity.com | sales@esslsecurity.com | Ph : 91-8026090500